



Architectural Control Committee
Plan and Specification Review Determination
PATIO, DECK, A/C, HOT TUB APPLICATION
(page 1 of 3)

ACC approval includes aesthetic features only and does not imply or warrant any structural integrity. This approval is not based on an engineering review of the site plan or structure. Please note: You may need the City of Mill Creek's permit and/or approval (425) 551-7254.

For MCCA Use Only

Submittal Number

11629

Date Submitted

11/1/2021

Please Attach
Color Samples
Here

Applications without
samples will not be
accepted.

Property owners
are responsible
for determining
all property lines,
locations, and
related
easements

Application may be
mailed, emailed
(info@mcca.info), or
dropped off at the MCCA
Office (15524 Country
Club Dr, Mill Creek, WA
98012)

01-May-19

Applicant Information

Name APRIL MORSLEY Ph. 425 280 2436

Email april.morsley@comcast.net

Site Information

Address 16324 18th AVE SE

Division AMBERLEIGH

Lot # 38

Type of Structure

Patio ☐ Deck ☐ A/C Unit ☒ Hot tub ☐

Est. Start Date: NOV 29, 2021 Est. End Date: NOV 30, 2021

You must attach a diagram, picture, or brochure of the proposed unit and show the exact location of the unit relative to your home and property lines.

Pursuant to the provision of Article VIII, paragraphs 8.1, 8.2, 8.2.1, 8.2.2, 8.2.3, 8.3, 8.3.1, 8.3.2, and 8.3.3 and Article IX of the Mill Creek Declaration of Covenants, the following determination by the Architectural Control Committee is hereby granted:

Approval subject to the following changes:

Rejected for the following reasons:

(☒) Approve () Reject

Condominiums & Townhomes ACC or Board Approval

Date: 10/26/21

() Approve () Reject

Date:

MCCA Administration

(☒) Approve () Reject

Chair, Architectural Control Committee

Date: 11/26/21

(☒) Approve () Reject

Earl Bardin

Date:

Bereket Abraha

Date:

(☒) Approve () Reject

Date:

() Approve () Reject

Date:

Amberleigh at Mill Creek

[Home](#) [Workers Amberleigh](#) [Workers MCCA](#) [Rules & Regulations](#) [MCCA Renters](#) [MCCA Forms](#)
[Amberleigh Floor Plans](#) [Amberleigh Map](#)

Patio, Deck AC/Heat Pump

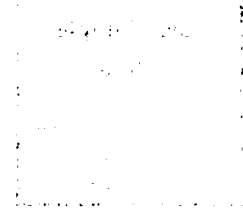

Amberleigh at Mill Creek
MCCA
Patio, Deck AC/Heat Pump
Form
1/1/2024

From: April aprilmorsley@comcast.net
Subject: Fwd: AC specs
Date: October 18, 2021 at 1:17 PM
To: April Morsley aprilmorsley@comcast.net



Sent from my iPhone

Begin forwarded message:

From: John Louzy <johnl@greenwoodheating.com>
Date: October 18, 2021 at 12:48:54 PM PDT
To: aprilmorsley@comcast.net
Subject: AC specs

Hi April,
I attached a copy of the specs for the AC unit. Please let me know if you need anything else for the HOA.
The size is
26" wide
26" deep
27 1/4" high.

Cancel

Markup



Done

1anmfg.com

Model	DIMENSIONS		
	W"	D"	H"
G5X130181E*	23	23	25 1/4
G5X130241E*	26	26	27 1/4
G5X130301E*	26	26	27 1/4
G5X130361E*	26	26	27 1/4
G5X130421E*	29	29	36 1/4

Handwritten signature

GSX130481B*	29	29	36 3/4
GSX130601B*	29	29	40
GSX130611A*	35 1/4	35 1/4	38 3/4



libertyhvac.com



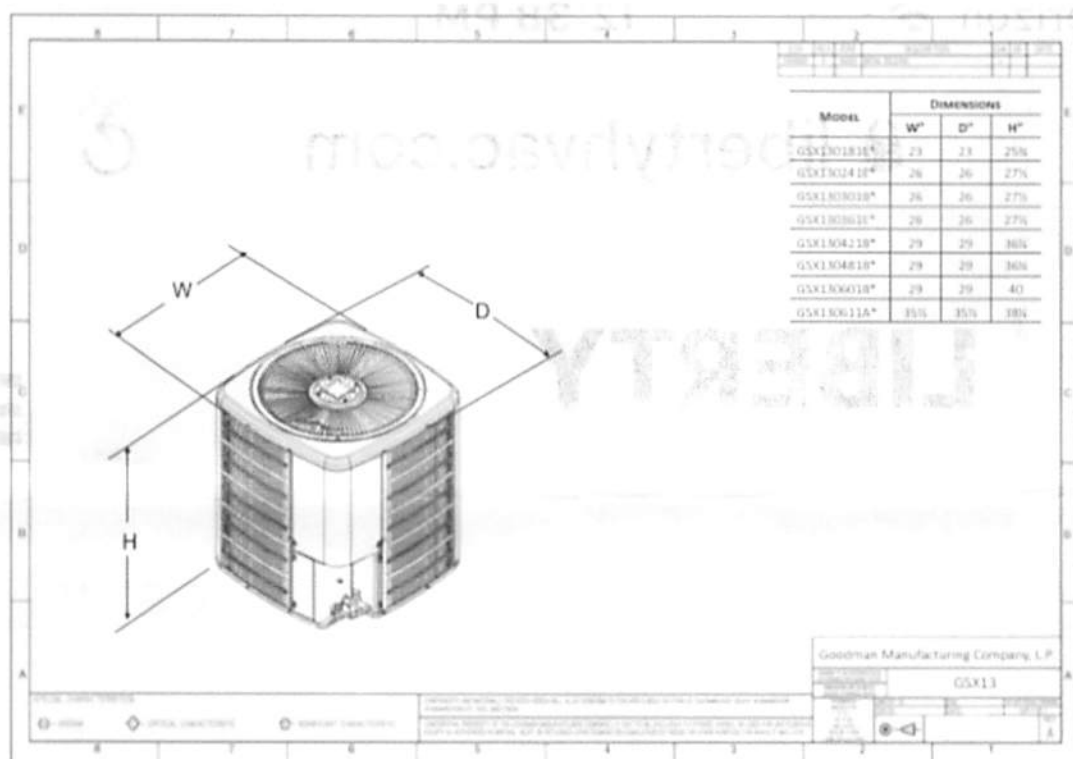

ACCESSORIES

MODEL #	DESCRIPTION	GSX13 018E*	GSX13 024E*/F*	GSX13 030B*/L*	GSX13 036E*	EGSX13 042**	GSX13 048**	GSX13 060**	GSX13 061**
ABK-20	Anchor Bracket Kit ^		X	X	X	X	X	X	X
ABK-21	Anchor Bracket Kit ^	X							
ASC-01	Anti-Short Cycle Kit	X	X	X	X	X	X	X	X
CSR-U-1	Hard-start Kit	X	X	X	X				
CSR-U-2	Hard-start Kit					X	X	X	X
CSR-U-3	Hard-start Kit						X	X	X
FSK01A ¹	Freeze Protection Kit	X	X	X	X	X	X	X	X
LSK02A ²	Liquid Line Solenoid Kit	X	X	X	X	X	X	X	X
0130R000005	Low-Pressure Switch Kit	X	X	X	X	X	X	X	X
LAKT01A	Low-Ambient Kit	X	X	X	X	X	X	X	X
TX2N4A ³	TXV Kit	X	X						
TX3N4 ³	TXV Kit			X	X				
TX5N4 ³	TXV Kit					X	X	X	X

* Contains 20 brackets; four brackets needed to anchor unit to pad

¹ Installed on indoor coil

³ First installed, non-bleed, expansion valve kit. Condensing units and heat pumps with reciprocating or rotary compressors require the use of start assist components when used in conjunction with an indoor coil using a non-bleed thermal expansion valve refrigerant metering device or liquid line solenoid kit

All AHRI system ratings are accessible in the System Configurator tool via PartnerLink.

Goodman Manufacturing Company, L.P., reserves the right to discontinue, or change at any time, specifications or designs without notice or without incurring obligations. © 2020 Goodman Manufacturing Company, L.P. • Houston, Texas • Printed in the USA.



Home / Products / Air Conditioners / GSX13



I WILL HAVE A FENCE AROUND
UNIT & PLAN TO PAINT THE
HOUSE COLOR TO BLEND IN.

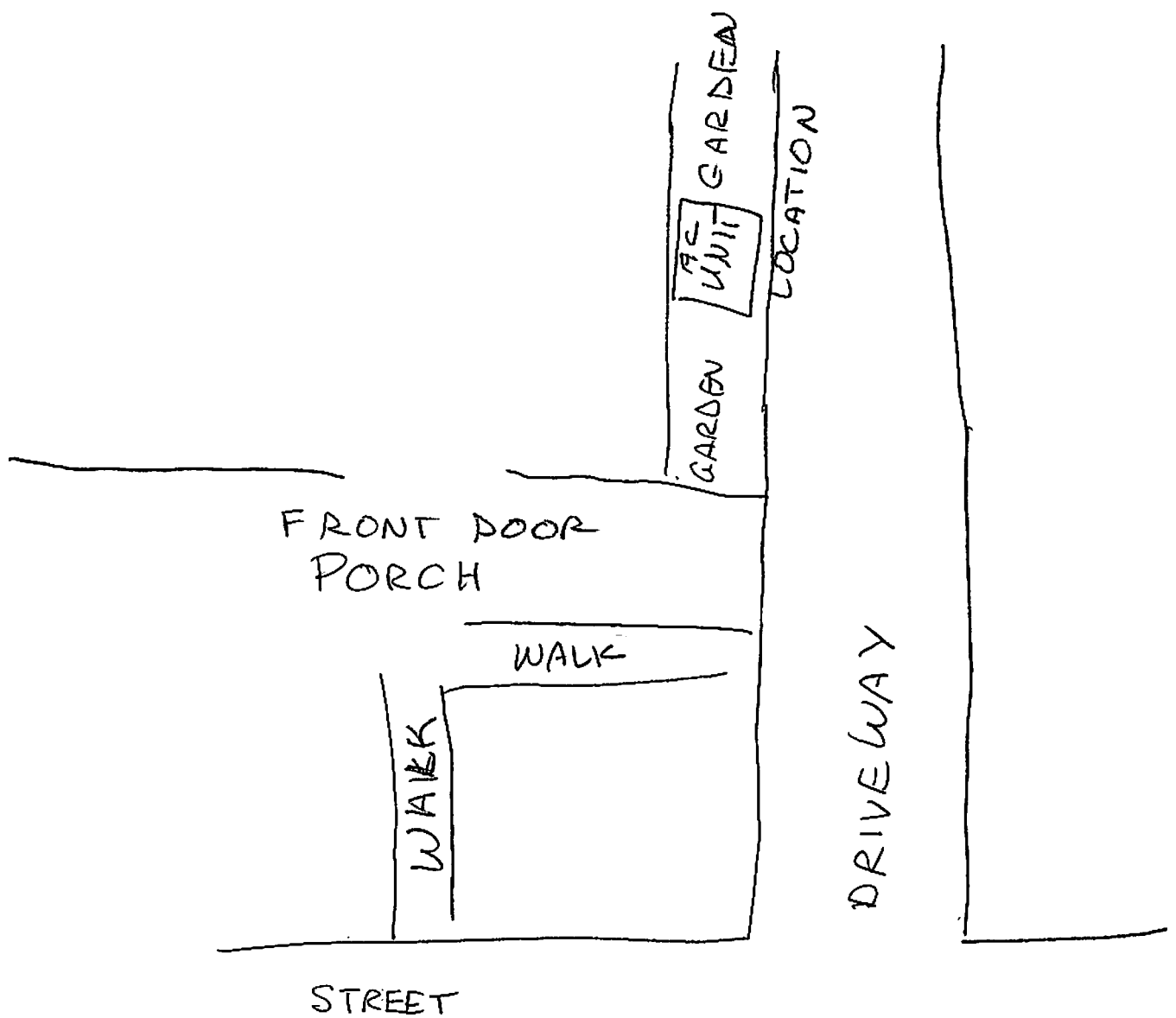

[Signature]